

Eva400EE

SWL
180 kg
400 lbs



Strong, safe and easy to manoeuvre – with electrical base widening

Eva400EE is a versatile mobile patient lift for all lifting situations and for users weighing up to 180 kg/400 lbs. When used with Handicare's functional and easy-to-use lifting accessories, Eva400EE is the right choice for lifting in connection with transfers to and from the floor, chair or bed, as well as for horizontal lifting and gait training.



Eva400EE

- Strong and stable, SWL 180 kg/400 lbs
- Aluminium for low weight – easy to manoeuvre
- Mast adjustable to three height positions – large lifting range
- Height-adjustable handle bars – comfortable and ergonomic working positions
- Stable aluminium sling bar with reliable safety latches
- Standard width sling bar - suitable for most users and situations
- Encapsulated twin castors – easy rolling and maintenance-free
- Electrical base widening
- Electrical emergency stop button readily available on the control box
- Electrical and manual emergency lowering
- High capacity battery with long service life
- External charger – only low voltage (24V) to the lift
- Quick guide on the lift
- Many accessories for safe, easy and individually adapted lifting of users



PRODUCT SPECIFICATION

Eva400EE _____ Art. No. 60100001

Mobile lift with electrical base widening, complete with SlingBar M and a hand control.

TECHNICAL INFORMATION

Safe working load (SWL) _____ 180 kg /400 lbs
 Material _____ Aluminium
 Total height _____ 1330-2020 mm /52.4-79.5"
 Base length _____ 1300 mm /51.2"
 Base width, outer dimensions _____ 685-980 mm /27-38.6"
 Base width, inner dimensions _____ 585-880 mm /23-34.7"
 Base widening _____ Electrical
 Total weight _____ 34 kg /74.5 lbs
 Castors, diameter _____ 100 mm /3.9"
 Lifting range _____ 500-1790 mm /19.7-70.5"
 Lifting speed without load _____ 37 mm/s /1.5"/s
 Emergency lowering _____ Manual and electrical
 Battery capacity _____ 2.9 Ah
 Material, sling bar _____ Aluminium
 Sling bar width _____ 450 mm /17.7"
 Protection class _____ IPX4

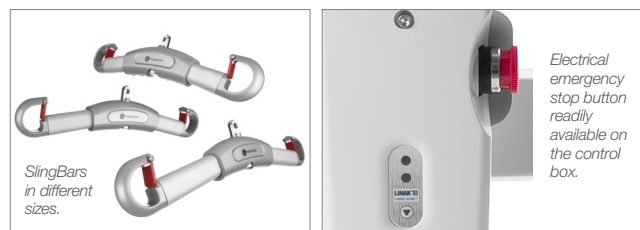

SlingBars in different sizes.

Electrical emergency stop button readily available on the control box.

ACCESSORIES

To create optimal solutions for users with different needs, Eva400EE can be used in combination with lifting slings and many other clever and functional lifting accessories in Handicare's lifting range.

Art. No.	Product name	Description
70200001	SlingBar S _____	Two-point aluminium sling bar, 35 cm/13.8"
70200003	SlingBar L _____	Two-point aluminium sling bar, 60 cm/23.6"
70200042	SlingBarSpreader M _____	Side bars for SlingBar S/M/L
70200006	StretcherBar _____	For horizontal lifting
70200017	Sling bar RFL X4 _____	Four-point steel sling crossbar
70100002	Charder MHS2500 _____	Scale, SWL 300 kg/660 lbs
70100003	Charder MHS2500 _____	Scale, SWL 400 kg/880 lbs
70200008	SwiftHook _____	For easy changing of sling bars



Eva400EE complies with requirements of the Medical Devices Directive for Class 1 products (MDD93/42/EEC).

Other models and variants of Eva mobile lifts

Eva mobile lifts are available in several models and variants with different lifting capacity and with electrical or manual base-width adjustment. They are also available in special versions with low legs for use with lower beds.

Art. No.	Product name	Description
60100011	Eva400EM	Mobile lift with manual base widening, SWL 180 kg/400 lbs
61000002	Eva450EE	Mobile lift with electrical base widening, SWL 205 kg/450 lbs
60100006	Eva450EE	Mobile lift with electrical base widening, low legs, SWL 205 kg/450 lbs
60100007	Eva450EM	Mobile lift with manual base widening, low legs, SWL 205 kg/450 lbs
60100003	Eva600EE	Mobile lift with electrical base widening, SWL 270 kg/600 lbs
60100010	Eva600EE	Mobile lift with electrical base widening, low legs, SWL 270 kg/600 lbs

Please visit www.handicare.com for more information.



Torshamnsgatan 35,
 164 40 Kista, Sweden
 Tel: +46 (0)8-557 62 200
 Fax: +46 (0)8-557 62 299
www.handicare.com
info@handicare.se